



**Ascention**  
Assets

## Refurbished 14.4m x 3.0m Two Room Portable Cabin

**Two Bedroom Refurbished Portable Accommodation Unit**

**P: 1300672343 | E: [info@ascention.com.au](mailto:info@ascention.com.au) | [www.ascentionassets.com.au](http://www.ascentionassets.com.au)**



**P: 1300672343 | E: [info@ascention.com.au](mailto:info@ascention.com.au) | [www.ascentionassets.com.au](http://www.ascentionassets.com.au)**



# Ascention Assets

**Contact us today if you require a  
Transportable Building**

**Description:** 14.4 x 3.0m Refurbished Portable Cabin  
**Buy Price:** POA  
**Hire Price:** POA  
**Availability:** Please contact us to confirm availability  
**Supplier Details:** Ascention Assets 1300672343





# Ascention Assets

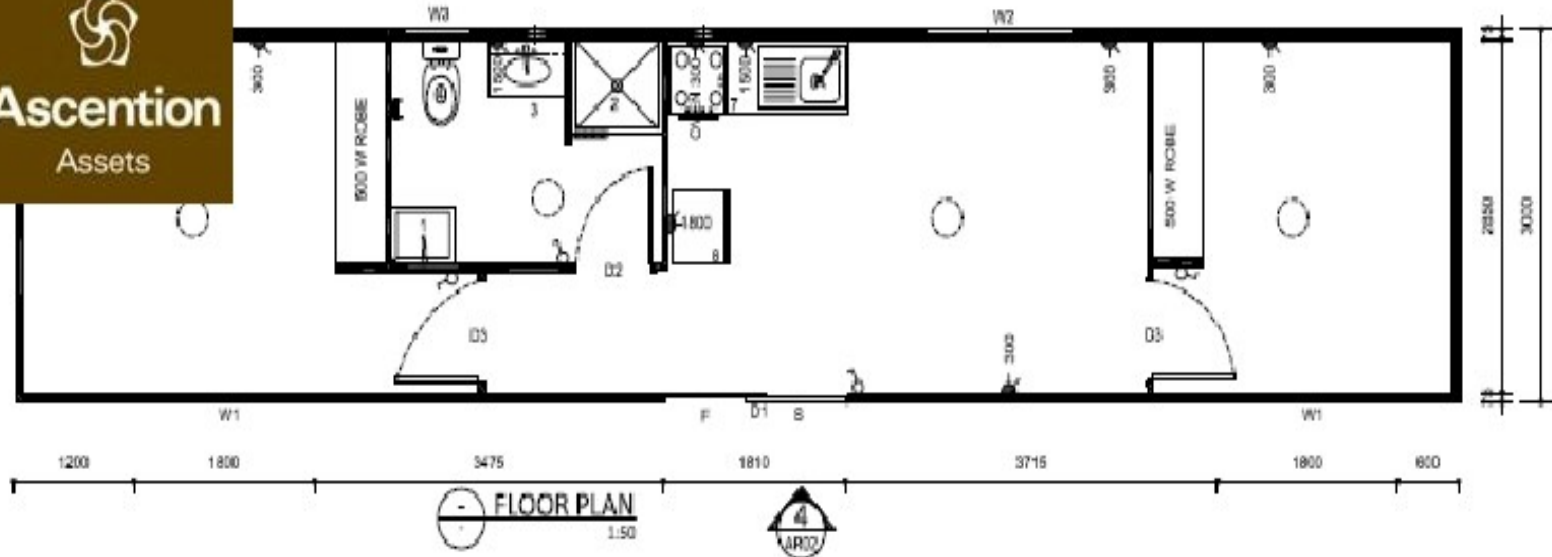

photographs, descriptions and condition reports (if any)  
should be used as a 'Guide Only'  
photograph shown is of a 14.4m x 3.0m layout

## Refurbished 14.4m x 3.0m Two Room Portable Cabin

### Specifications:

- Engineered plans for the shire
- Energy Efficiency Certificate
- Colorbond external cladding
- Vinyl floor covering
- Kitchen with overhead cupboards, single bowl sink and tapware
- Euromaid 600mm freestanding oven, under cupboard slide out rangehood and 228L fridge
- Wardrobes to both bedrooms with sliding vinyl doors, shelf and cloths rail
- Internal hinged door Qty 3
- Colorbond external flashings
- 1800mm W sliding glass door Qty 1
- Windows: 1800mm W x 2100mm H
- Qty 2, 1500mm W x 1200mm H Qty 1 and 350x730mm W PV Qty 1 Key lock windows with flyscreens.
- Bathroom: 700mm vanity, acrylic splashback, 600mm mirror and shaving cabinet, toilet roll holder, towel rail, shower module with shower rail and mixer, toilet and cistern, laundry trough with washing machine taps.
- Power points: Qty 8 double power points.
- Internal fluoro lights Qty 5
- External bunker light Qty 1

Descriptions and photographs should be used as a guide only